

INSTRUCTIONS: LED Pendant
Model: LED311, LED314, LED315

INSTRUCTIONS PERTAINING TO A RISK OF FIRE, OR INJURY.
Save these instructions.

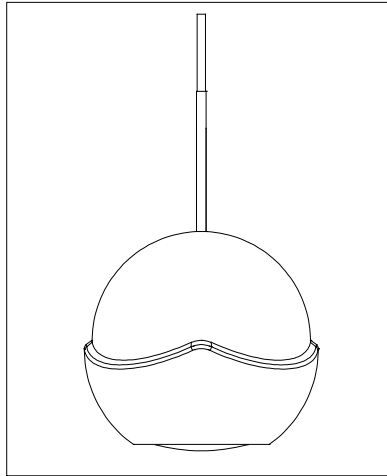

LED311

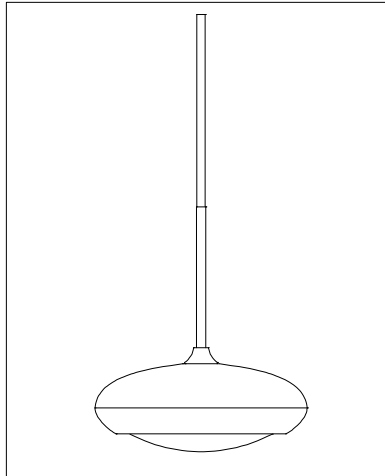

LED314

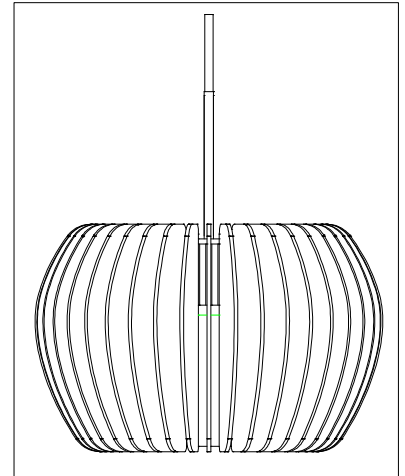

LED315

Overview:

Pendant sockets sets are designed for use with all WAC quick connect adapters. They may also be used on other manufacturers brand of quick connect (consult factory for compatibility). Pendants may be mounted to mono rail, monopoints, or line volt track, by coupling to a low voltage quick connect adapter. Sockets are supplied with a 6' cable and may be field cut to desired length.

Installing Pendant to Quick Connect:

1. Insert the post of the quick connect into the quick connect adapter.
2. Thread the top half of the conical section until it seats with the adapter.
3. Adjust fixture position, use caution not to loosen the conical section.

See reverse for field shortening pendants.

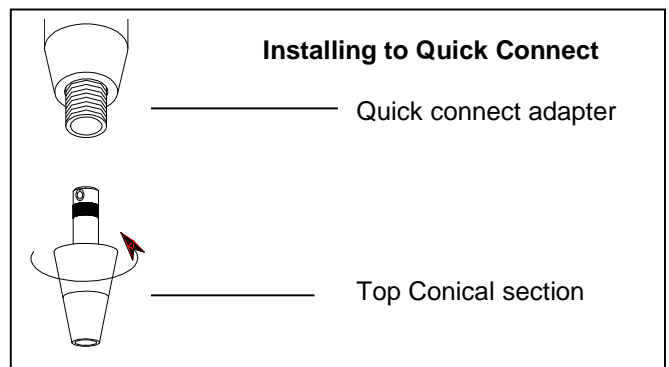

To Install/ Shorten Pendant:

All Pendant shades use the quick connect adapter to attach to the rail. On the QP-601 the mating piece (top conical section) for quick connect adapter comes uninstalled. Feed the cable end through the glass shade and the metal finial. If cable needs to be shortened, make the cut now. To install the top conical section, follow the step-by-step instructions bellow. **NOTE: Pendant cables are co-axial, if the lower screw in step 4 is made too tight, the inner an outer wire will short. A short circuit will render the entire system in-operative and possibly damage the transformer. Check all pendant splices for continuity before installing.**

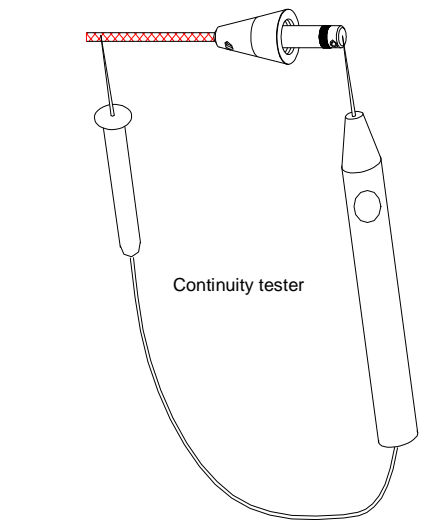
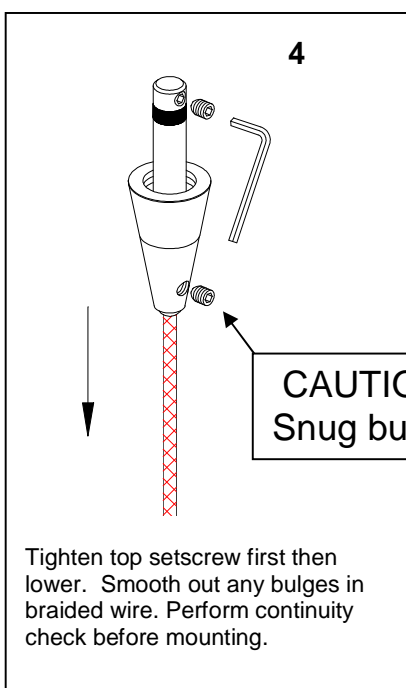
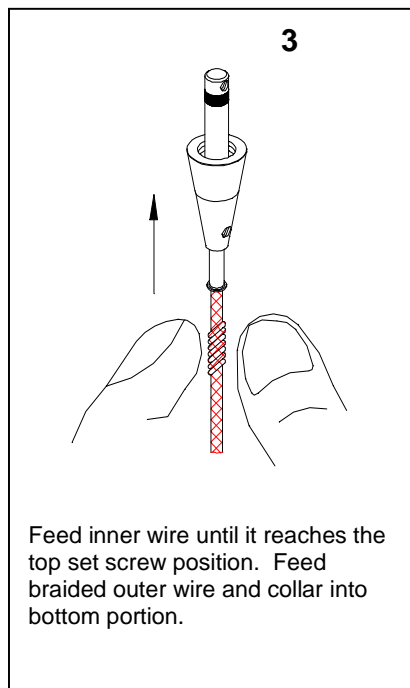
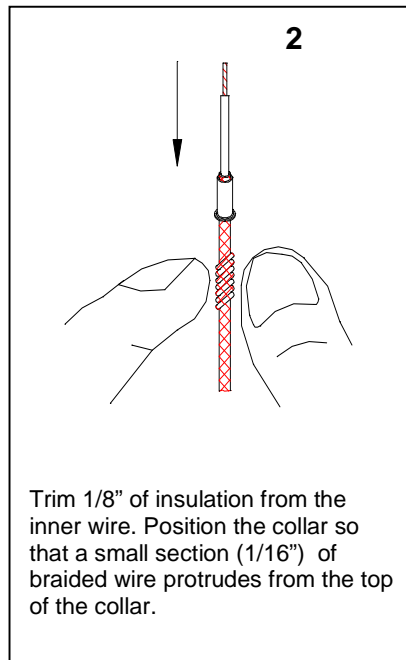
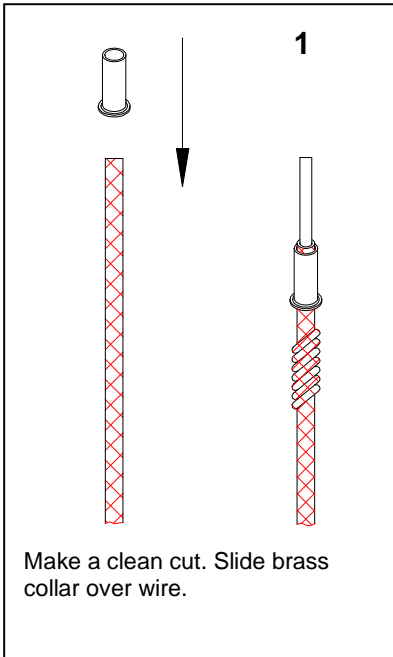

Check Splice:
Before mounting, with lamp removed from the socket, check for continuity. There should be none.

Insert lamp in socket and re-check. There should now be continuity, indicating a completed circuit.

Install with power off.

INSTRUCTIONS:

Quick Connect Canopies Models: QMP-G1RN

CAUTION:

Read all instructions.

Do not conceal or extend exposed conductors through a building wall.

Do not install this system in wet locations.

For low voltage exposed insulated conductor systems required by 30.1© do not install any part of this system less than 7 feet (2.2m) above the floor.

To reduce the risk of fire and burns, do not install this lighting system where the exposed bare conductors can be shorted or contact any conductive materials.

To reduce the risk of fire and overheating, make sure all connections are tight.

Do not install any luminaire closer than 6 inches (15.25 cm) from any curtain, or similar combustible materials.

Turn off electrical power before modifying the lighting system in any way.

SAVE THESE INSTRUCTIONS

Overview: Canopies are designed to fit all WAC quick connect fixtures. They may also be used on other manufacturers brand of quick connect (consult factory for compatibility). Uses a 50 watt max fixture or pendant.

Canopies come with a self-contained electronic transformer that may be dimmed with an electronic low volt dimmer switch.

1. Loosen the three canopy screws and separate the canopy from the base plate.
2. Remove a knock out from the base plate.
3. Support canopy and guide the black and white wires and from the transformer through the knock out in the base plate and into the Junction box.
4. Connect ground wire from junction box to the green grounding wire from the base plate.
5. Connect corresponding line volt wires from the junction box to transformer wires, with wire nuts (supplied). Tuck excess wire into the junction box.
6. Attach the base plate to the junction box using the slotted holes.
7. Raise the canopy to the base plate, and tighten the three screws loosened earlier.

Retain instructions for future reference.

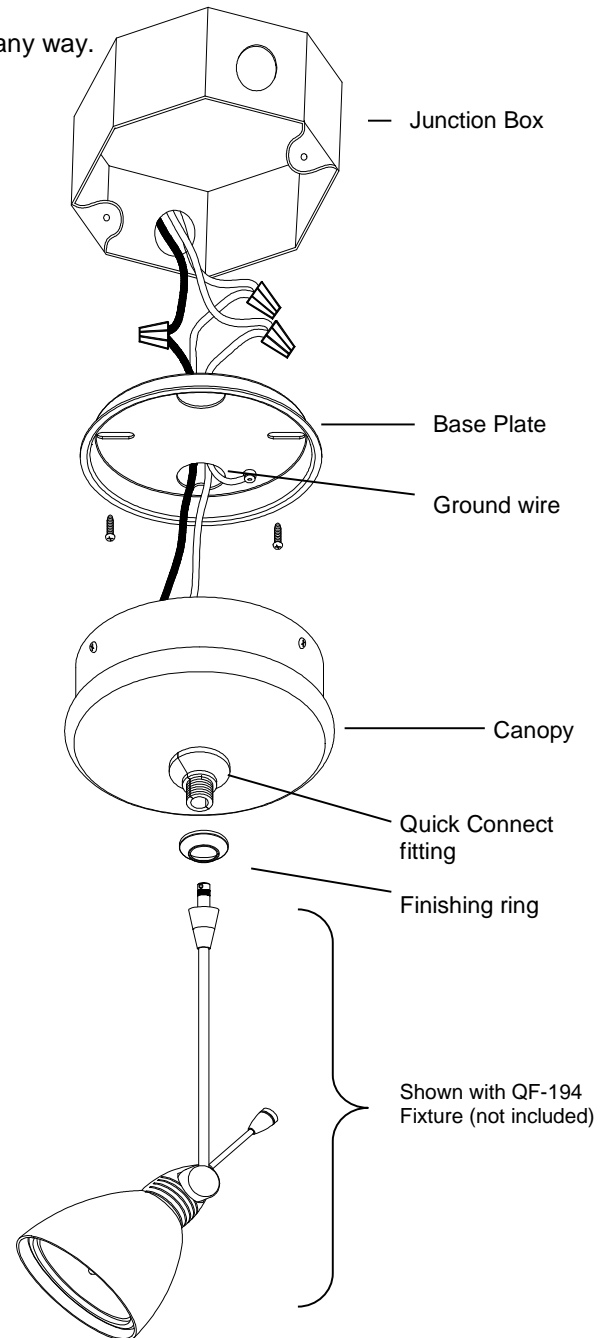

INSTRUCTIONS:

Models:

Quick Connect Canopies

QMP-G3RN

CAUTION:

Always turn off power at fuse box prior to installation to prevent electrical shock.

For installation by a qualified electrician.

Line voltage wire must be 12AWG BX or Romex wire.

Install over a standard 4 inch junction box.

All wires must be contained in the junction box.

Overview: Canopies are designed to fit all W.A.C quick connect fixtures. They may also be used on other manufacturers brand of quick connect (consult factory for compatibility). Uses three fixtures or pendants, 50 watt max each.

Canopies come with self-contained electronic transformers that may be dimmed with an electronic low volt dimmer switch.

1. Loosen the canopy screws and separate the canopy from the base plate.
2. Remove a knock out from the base plate.
3. Support canopy and guide the black and white wires and from the transformer through the knock out in the base plate and into the Junction box.
4. Connect ground wire from junction box to the green grounding wire from the base plate.
5. Connect corresponding line volt wires from the junction box to transformer wires, with wire nuts (supplied). Tuck excess wire into the junction box.
6. Attach the base plate to the junction box using the slotted holes.
7. Raise the canopy to the base plate, and tighten the three screws loosened earlier.

Retain instructions for future reference.

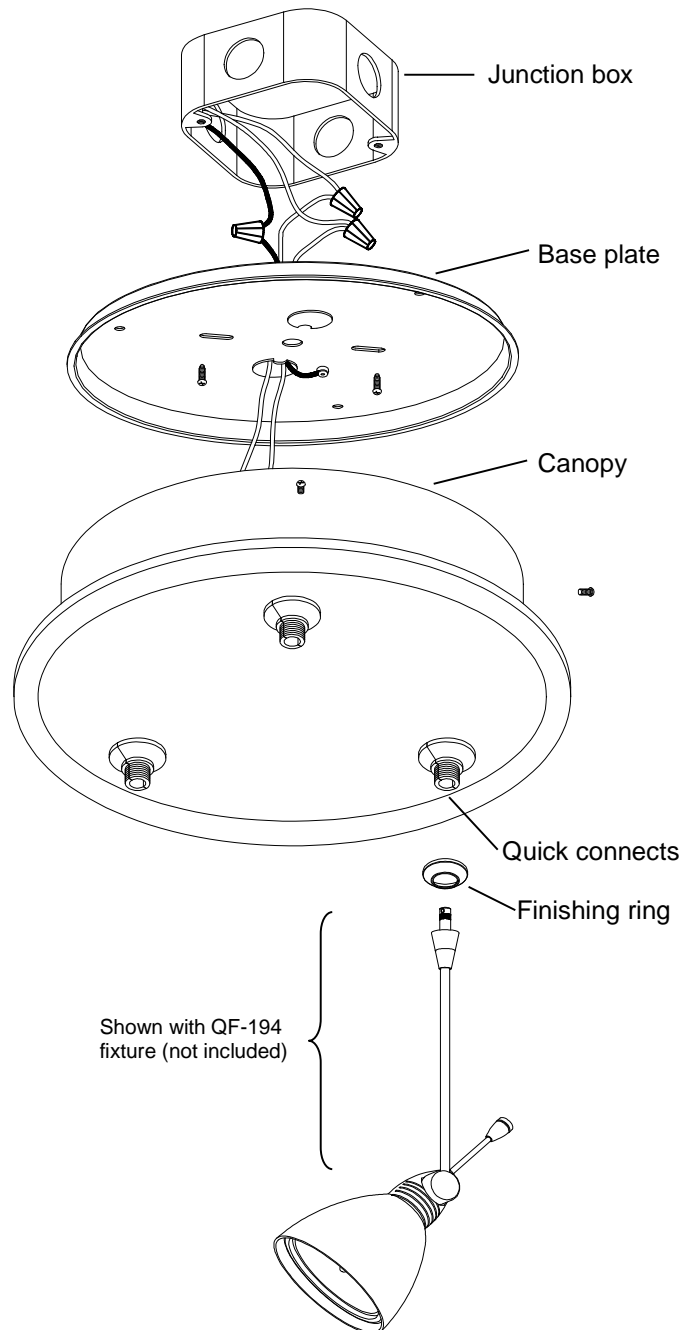

WAC LIGHTING
Responsible Lighting®

Retain these instructions for future service and adjustments
44 Harbor Park Drive, Port Washington, NY 11050
Tel: (800) 526-2588 Fax (800) 526-5050
www.waclighting.com

Instruction:
Model:

Quick Connect Canopies
QMP-G6RN

CAUTION:

Always turn off power at fuse box prior to installation to prevent electrical shock.
For installation by a qualified electrician.
Line voltage wire must be 12AWG BX or Romex wire.
Install over a standard 4 inch junction box.
All wires must be contained in the junction box.

Overview: Canopies are designed to fit all WAC quick connect fixtures. They may also be used on other manufacturers brand of quick connect (consult factory for compatibility). Uses three fixtures or pendants, 50 watt max each. Canopies come with self-contained electronic transformers that can generally be used with low voltage electronic dimmer switches.

1. Loosen the canopy screws and separate the canopy from the base plate.
2. Remove a knock out from the base plate.
3. Support canopy and guide the black and white wires and from the transformer through the knock out in the base plate and into the Junction box.
4. Connect ground wire from junction box to the green grounding wire from the base plate.
5. Connect corresponding line volt wires from the junction box to transformer wires, with wire nuts (supplied). Tuck excess wire into the junction box.
6. Attach the base plate to the junction box using the slotted holes.
7. Raise the canopy to the base plate, and tighten the three screws loosened earlier.

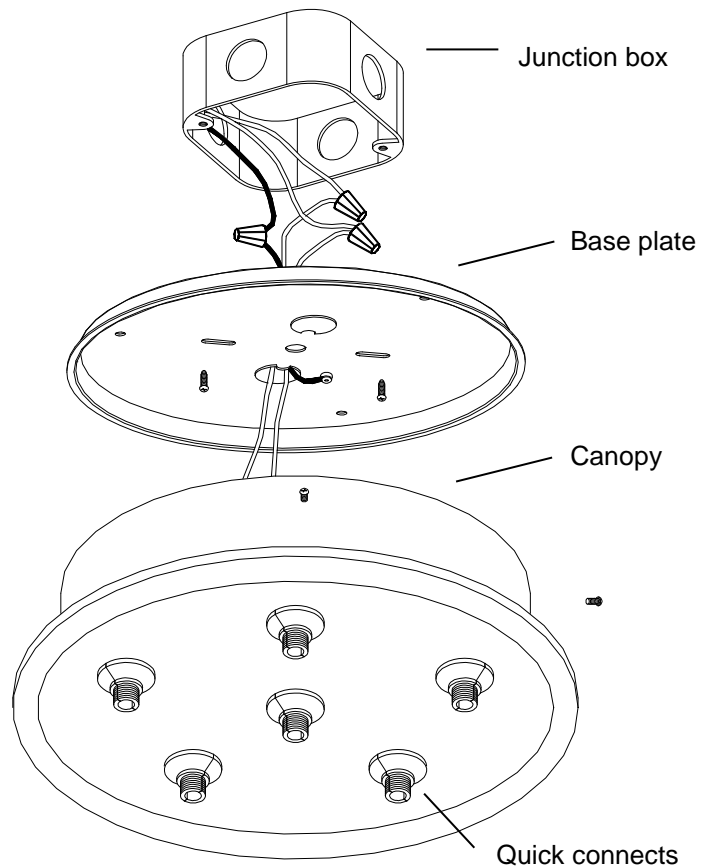

Retain instructions for future reference.

Instruction:
Model:

Quick Connect Canopies
QMP-G12RN

CAUTION:

Always turn off power at fuse box prior to installation to prevent electrical shock.
For installation by a qualified electrician.
Line voltage wire must be 12AWG BX or Romex wire.
Install over a standard 4 inch junction box.
All wires must be contained in the junction box.

Overview: Canopies are designed to fit all WAC quick connect fixtures. They may also be used on other manufacturers brand of quick connect (consult factory for compatibility). Uses three fixtures or pendants, 50 watt max each. Canopies come with self-contained electronic transformers that can generally be used with low voltage electronic dimmer switches.

1. Loosen the canopy screws and separate the canopy from the base plate.
2. Remove a knock out from the base plate.
3. Support canopy and guide the black and white wires and from the transformer through the knock out in the base plate and into the Junction box.
4. Connect ground wire from junction box to the green grounding wire from the base plate.
5. Connect corresponding line volt wires from the junction box to transformer wires, with wire nuts (supplied). Tuck excess wire into the junction box.
6. Attach the base plate to the junction box using the slotted holes.
7. Raise the canopy to the base plate, and tighten the three screws loosened earlier.

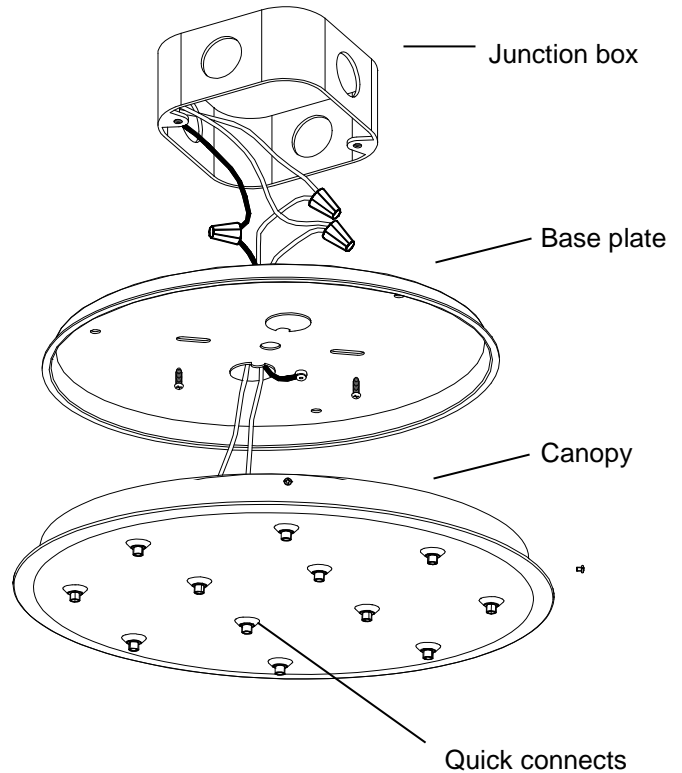

Retain instructions for future reference.