

GAIA – model: WS-W327
 dwelLED™ LED Outdoor

WAC LIGHTING
 Responsible Lighting®

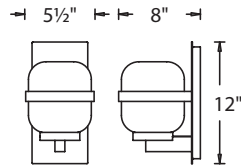

WS-W32712

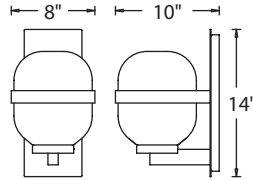

WS-W32714

Fixture Type:

Catalog Number:

Project: _____

Location: _____

PRODUCT DESCRIPTION

Mid-century modern refined with a contrast of black and white elements that look great together. Gaia features a mouth blown etched opal glass with solid die cast aluminum hardware that is weather resistant with a powder coated finish. The light engine is factory sealed for maximum protection against the harshest elements.

FEATURES

- Black and white have never looked so good together
- Light engine is factory sealed for maximum protection from the elements
- Replacement glass available
- Weather-resistant powder coated finish
- Mouth blown etched triplex opal glass
- No transformer or driver required
- Color Temp: 3000K
- CRI: 90
- Dimming: 100% - 0% ELV
- Rated Life: 44,000 hours
- Input: 120V

SPECIFICATIONS

Construction: Aluminum and Mouth Blown Opal Glass

Light Source: High output LED.

Finish: Black (BK)

Standards: ETL & cETL wet location listed. IP 65.

Replacement Glass

| | |
|----------------------|-----------|
| RPL-GLA-32712 | 12" Glass |
| RPL-GLA-32714 | 14" Glass |

ORDER NUMBER

| | | Watt | LED Lumens | Delivered Lumens | Finish |
|-----|------------------|------|------------|------------------|-----------------|
| 12" | WS-W32712 | 9.5W | 625 | 495 | BK Black |
| 14" | WS-W32714 | 12W | 755 | 635 | |

Example: **WS-W32714-BK**

waclighting.com
 Phone (800) 526.2588
 Fax (800) 526.2585

Headquarters/Eastern Distribution Center
 44 Harbor Park Drive
 Port Washington, NY 11050

Central Distribution Center
 1600 Distribution Ct
 Lithia Springs, GA 30122

Western Distribution Center
 1750 Archibald Avenue
 Ontario, CA 91760