

CATALOG NUMBER	TYPE
PROJECT	

FLEXRAIL2™ – QUICK CONNECT TRANSFORMER ADAPTOR

HM-EN50

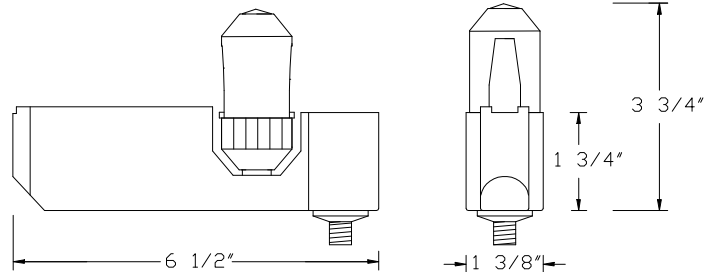

Ordering Matrix			
Model	Series	Finish	
HM	EN50	PT	BZ

Ordering Example (model number – series – finish): HM-EN50-PT

Product Details	
Description:	The HM-EN50 is a track adaptor with an integral 50 watt electronic transformer. The quick connect transformer adaptor allows low voltage quick connect elements, either track heads or pendants, to be used with the Flexrail2™ track system.
Materials:	Polycarbonate case with metal fittings for attaching to rail. Transformer is a high frequency 12V electronic transformer.
Fixtures:	Compatible fixtures include all the elements in the WAC Lighting quick connect series of pendants and track heads.
Finish:	Abrasion resistant platinum or bronze paint finish. PT = Platinum metal finish BZ = Designer Bronze metal finish
Input:	120V (50/60Hz)
Output:	12V
Dimming:	Dimmable with electronic low voltage dimmers.
Listing:	UL & CUL Listed.

Specification Features
<ul style="list-style-type: none"> The HM-EN50 threaded nipple is compatible all with the following quick connect pendant socket sets; QP-201, QP-501, QP-502, QP-601 QP-701, QP-801, QP-901, QP-902 Transformer adaptor is easy to install and blends seamlessly into the Flexrail2™ track system. By using the HM-EN50 with the Flexrail2™ system, it allows you to use MR16 and other low voltage lamps with the bendable line voltage rail system. 5 year WAC Lighting product warranty.