

CATALOG NUMBER	TYPE
PROJECT	

LED Constant Current Driver **MODEL LED-700MA12-P**

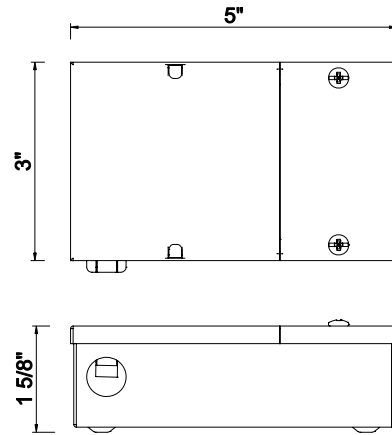

Ordering Matrix	
Model	Finish
[]	[]
LED-700MA12-P	BK

Ordering Example (Model) : LED-700MA12-P

Product Details	
Description:	Compact and reliable constant current LED power supply for up to four LED-SL101 display showcase lights
Input Voltage:	120V AC
Input Current:	0.2A
Output Voltage:	12V DC MAX
Output Current:	700mA DC constant current
Load:	12W Maximum
Loading Wire:	22 AWG. 6 ft maximum length
Listing:	U.L. listed, File Number E325675

Specification Features
<ul style="list-style-type: none"> • U.L. 60950 listed LED driver. • Low profile as 1 5/8" thickness • 700mA Constant Current for LED's optimized and stable performance. • "Plug and Play" terminal blocks for wiring up to four LED-SL-101 display showcase lights • Surge protection • Short circuit protection to protect • 5 year W.A.C Lighting product warranty