

CATALOG NUMBER	TYPE
PROJECT	

3" PREMIUM LOW VOLTAGE TRIM

HR-D333

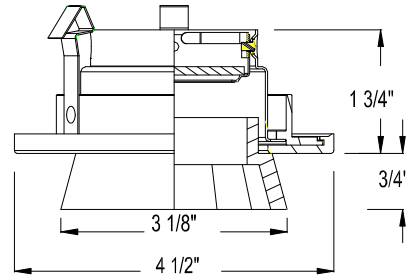

Ordering Matrix				
Series	Model Number	Finish (Glass / Trim)		Lamp
HR	D333	AM/WT	WT/WT	50w max MR16

Ordering Example (series – model number – finish): HR-D333-AM/WT

Product Details		Specification Features
Description:	Open reflector trim with decorative flared glass cylinder element for use with HR-300 series low voltage downlight housings. The glass element diffuses the high angle light, providing general white light below and a soft colored glow pattern on the ceiling.	<ul style="list-style-type: none"> The supplied clear glass lens can be replaced with one lens accessory such as a colored dichroic lens, UV filter lens, frosted lens, etc. See catalog or website for full lens accessory selection. The three inch die-cast series is the smallest performance trim available for both commercial and residential lighting projects. Handles ceiling thickness up to 3/4". 5 year WAC Lighting product warranty.
Materials:	Powder coated finish on die-cast aluminum. Glass elements are solid colored cased glass. Inner die-cast aluminum trim body with three heavy gauge retention clips to firmly hold trim to housing.	
Lamping:	Utilizes 12volt MR16 lamps, 50w max. Ordered separately. Trim supplied with clear tempered glass lens cover for lamp.	
Finish:	AM/WT = Amber glass element with white trim WT/WT = White glass element with white trim	
Listing:	UL & CUL Listed. Suitable for damp locations.	

Compatible Housings (sold separately):			
HR-301E Non IC Remodel Installations 12 Volt Electronic Transformer Lamp: MR16 50W Max		HR-301M Non IC Remodel Installations 12 volt Magnetic Transformer Lamp: MR16 50W Max	
HR-302E Non IC New Construction 12 Volt Electronic Transformer Lamp: MR16 50W Max		HR-302M Non IC New Construction 12 Volt Magnetic Transformer Lamp: MR16 50W Max	